



CONSTRUCTION ALERT-042

Upcoming Construction Activities

Temporary closure of NW Access from Lot A to Cox Bldg

- **NW Access Path Closure**

The NW Access Path from Lot 1 to Cox Bldg will be closed from 6 AM, Monday, June 18, 2007 and is scheduled for reopening 7 AM on Monday July 9, 2007. Pedestrian access from Lot 1 to Imperial Main entry to the Quad will be available during this time.

- **Impact:** Pedestrian access will be solely from Lot 1 to Imperial Main entry to the Quad during this time.



INSERT

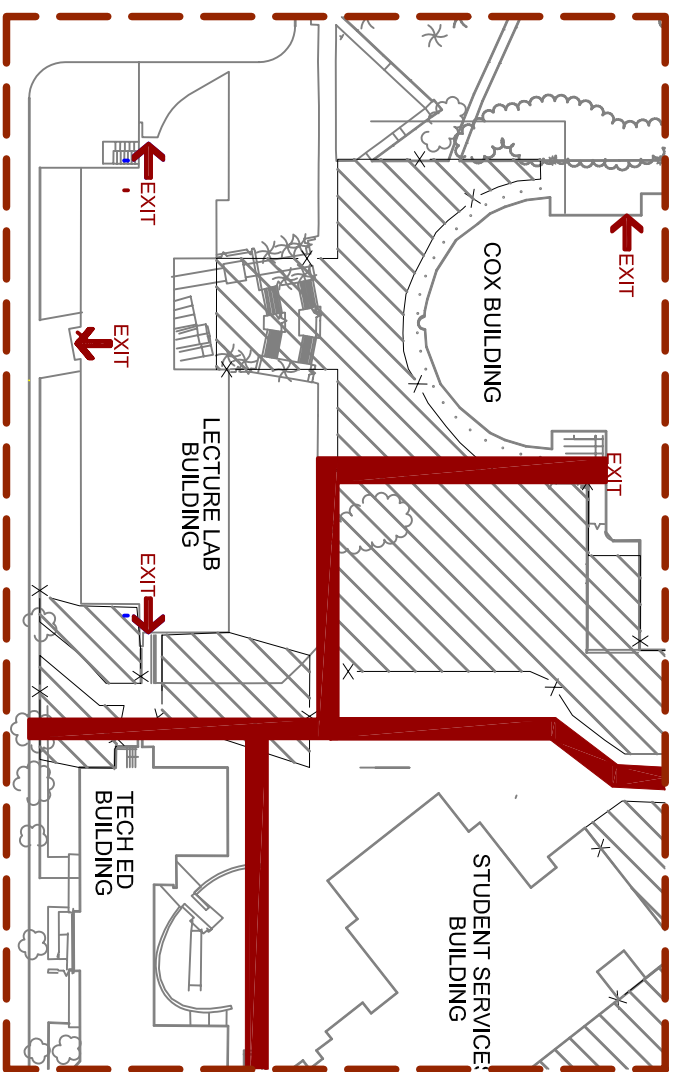

**EXISTING PEDESTRIAN CIRCULATION PATH
TO BE CLOSED UNTIL AUGUST 15TH. NEW
CIRCULATION PATH INDICATED IN YELLOW**

- PATH OF TRAVEL
- AREAS TO BE UNDER CONSTRUCTION IN SUMMER OF 2007

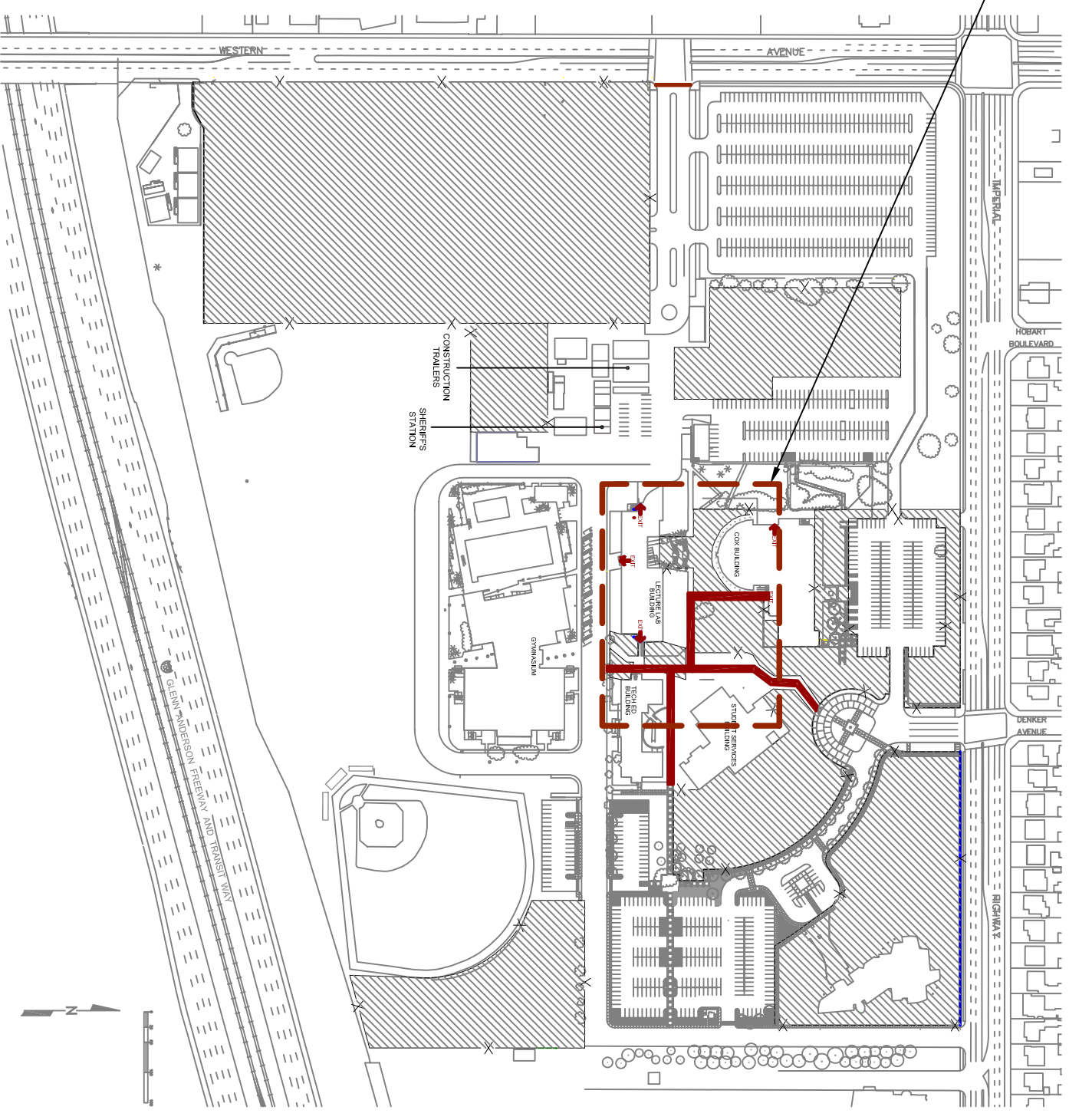

CAMPUS MAP - SUMMER 2007